



# TOYOTA

M247

## URBAN CRUISER

PARTNUMBERS : 08611-52850

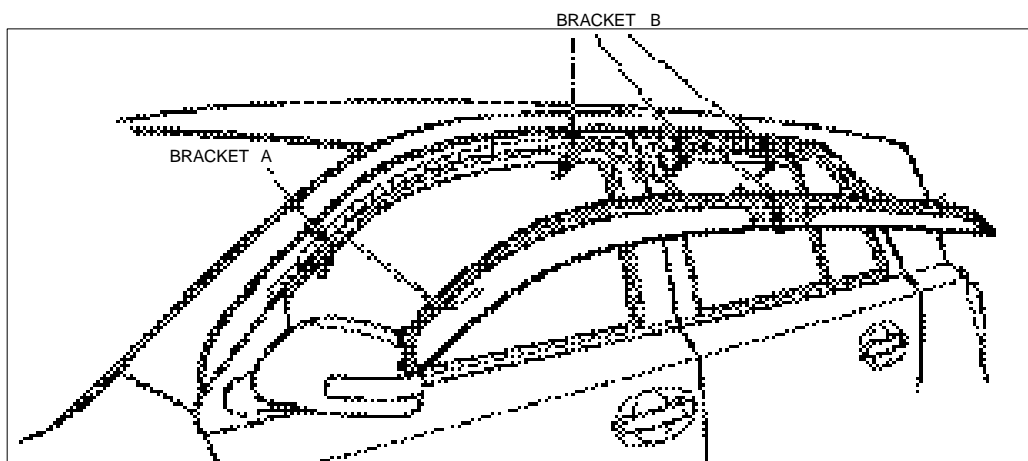

### KIT CONTENT - STÜCKLISTE - CONTENU - KIT INHOUD

Please refer to the enclosed installation diagram.

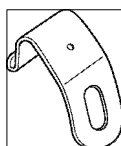
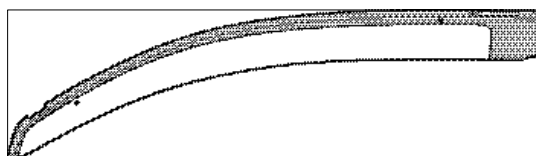

No.	Part name	Qty.
1	VISOR FRONT	2
2	VISOR REAR	2
3	BRACKET A	2
4	BRACKET B	6
5	RIVET	8
6	CAP	8

Weight : 1.0 kg  
Installation time : 25 minutes  
Installation temperature : 18° - 25°C

INSTALLATION MANUAL-ANBAU ANLEITUNG-MONTAGE HANDLEIDING-MANUEL D'INSTALLATION

英

Issue : 01

Page : 1/4

Date : 28-July-08

PARTNAME : SIDE VISOR

PARTNUMBER : ALL 4/5-DOOR MODELS



## APPLICATION/ANWENDUNG/APPLICATIE

MODEL CODE :

😊					☹️				
VEHICLE OPTION/FAHRZEUG OPTION/OPTION VEHICULE/VOERTUIG OPTIE					VEHICLE OPTION/FAHRZEUG OPTION/OPTION VEHICULE/VOERTUIG OPTIE				
1					1				
2					2				
3					3				
4					4				
5					5				
6					6				
7					7				
8					8				
9					9				
10					10				
ACCESSORY/ZUBEHÖR/ACCESSOIRE					ACCESSORY/ZUBEHÖR/ACCESSOIRE				
1					1				
2					2				
3					3				
4					4				
5					5				
6					6				
7					7				
8					8				
9					9				
10					10				
SAFETY PRECAUTION/SICHERHEITSMASSNAHME/PRECAUTIONS DE SECURITE/VEILIGHEIDVOORZIENINGEN									

	Step/Punkt/Point/Stap
--	-----------------------

## TOOLS/WERKZEUGE/OUTILS/WERKTUIGEN

	CLEANER		DRYER	
---	---------	---	-------	--

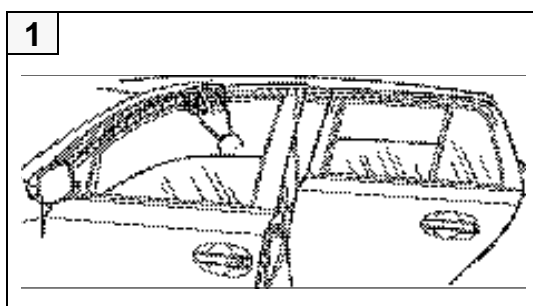
**1. Cleaning of contact surface**

- Open the door and lower the window.
- Use a clean cloth soaked in cleaner and wipe away all dirt, oil or moisture around the contact surface.

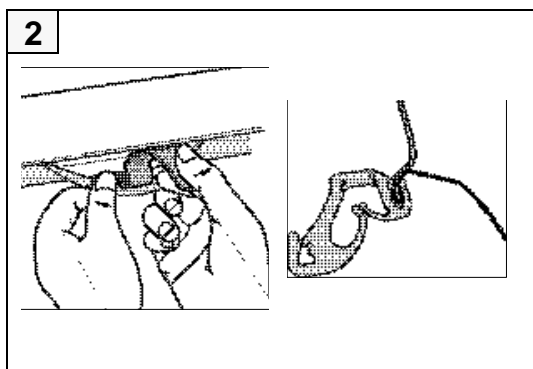
**2. Preliminary fitting of bracket**

- Place the visor temporarily on the vehicle, referring to the enclosed installation outline diagram, and mark the position of the brackets using a water based pen.
- While pulling back the glass run around the marked positions estimated in step "a." insert the brackets at these positions.

**Note:**

Use finger pressure to assure a good fit between the bracket and the glass run. Unless returned to its original position, the glass run may be scratched or torn



**Critical operation**  
**Specifics tools**



**Operator safety**



**Check point**

英

Issue : 01

Page : 2/4

Date : 28-July-08

3

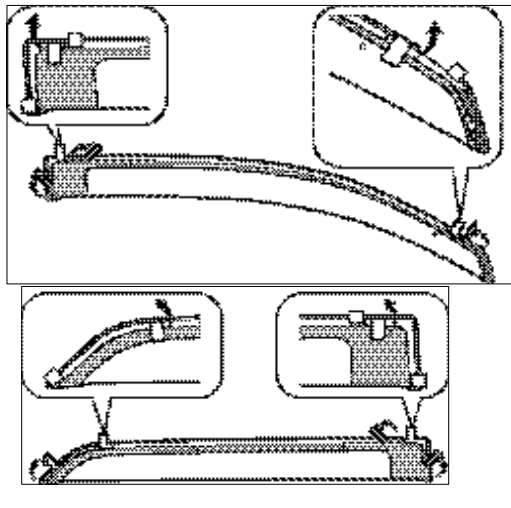

### 3. Preliminary steps for visor unit installation

- At both ends of the visor, peel back about 2 - 3 cm of the release paper on the double sided adhesive tape and fold the peeled portion upwards



4

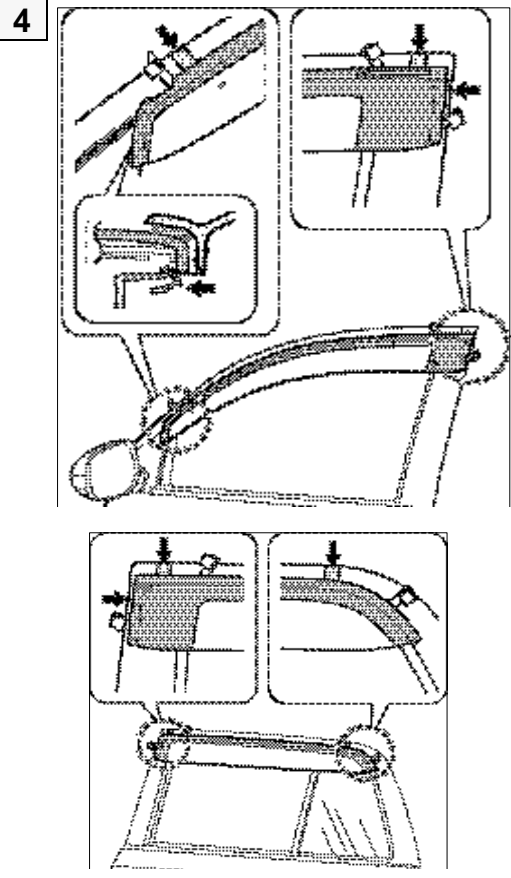

### 4. Setting the visor position

- While the front edge of the bracket is inserted into the mirror base, push in (align) the visor edge.
- Position the visor on the door, **referring to the enclosed installation outline diagram**. Pay attention to good fitting against the door so that the tape will have a good adhesion over the complete surface.



5

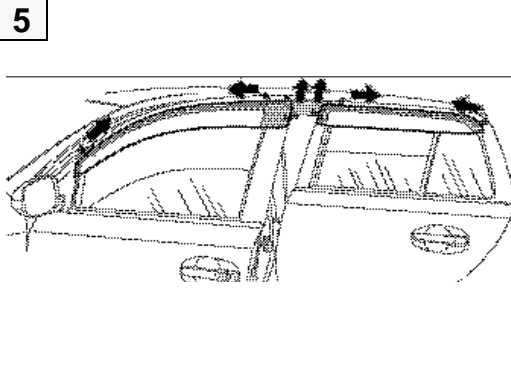

### 5. Attaching visor

- While peeling off the release paper on the double sided adhesive tape in the direction of the arrow, using care not to twist the paper, affix the visor to the door panel.



Critical operation  
Specifics tools

英

Issue : 01



Operator safety



Check point

6

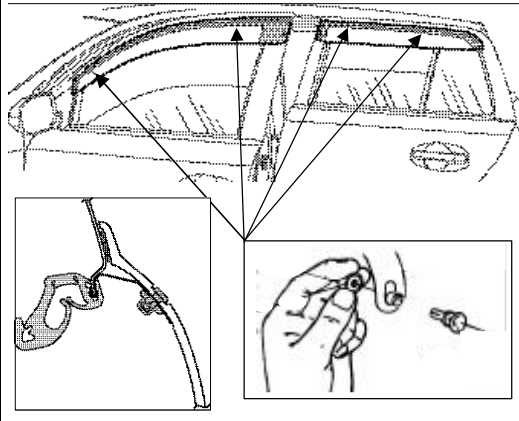

#### 6. Securing visor and bracket

- a. Adjust the bracket so that the holes in the visor and bracket are aligned, and fix the visor and bracket in place using a rivet and cap



7

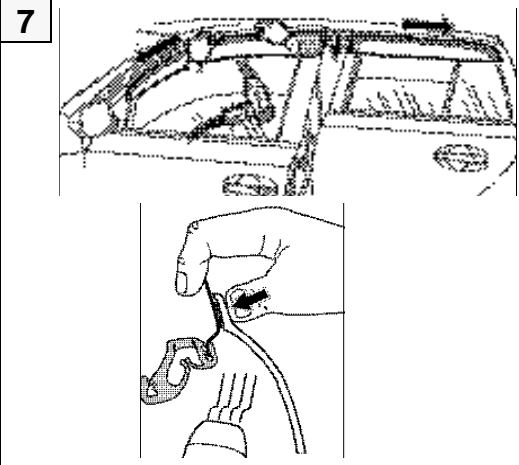

#### 7. Heated Pressure; adhesion of visor

- a. After affixing the visor, use a dryer to moderately heat the bonding portion of the double sided adhesive tape while pressing on the visor in order to obtain a good adhesion.



#### Note:

\* Heating at an too high temperature can cause visor deformation.

\* If poorly bonded the visor, particularly the front tip and rear end , can peel off or generate wind noise. Apply pressure to bond correct

8

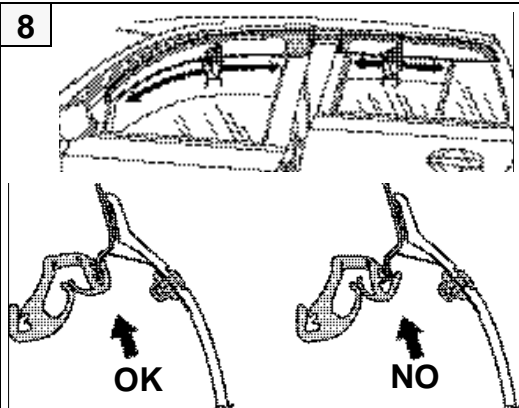

#### 8. Glass run check

- a. Apply finger pressure so that glass run fits well with the door panel and the bracket



#### Note:

\* The glass run particularly at the bracket attachment sections must be made to fit very well. Otherwise the glass run may be damaged. Care must be taken to obtain a satisfactory fit

9

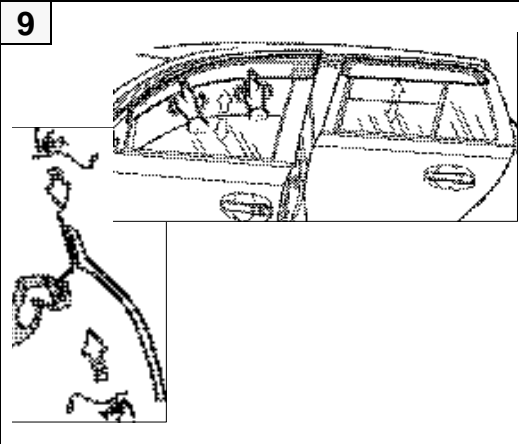

#### 9. Final check

- a. Pull the side visor toward you to make sure it is attached firmly
- b. Raise and lower the window to make sure that the glass run is not pinched or caught anywhere
- c. Check to make sure the visor does not interfere with the vehicle body sections when the door is opened and closed.



#### Note:

\* Viewing from the arrows in the figure, check to make sure a tight seal has been formed along the adhesive surface of the visor

\* Do not allow the visor to get wet from rain, car wash or other water for 20 min. after installation



Critical operation  
Specifics tools

英

Issue : 01



Operator safety



Check point