



Auris

Scuff Plates 5-door

Installation instructions



Model year: 2006

Vehicle code: **E15**-*H***W

Part number: PZ467-E2180-00 /PZ467-E0180-00



Weight: 0,2 kg

Manual reference number: AIM 000 791-1

Revision Record

Rev. No.	Date	Page	Picture	Update	New	Deleted Steps
1	10-5-2010	all	none	pnr added	-	-

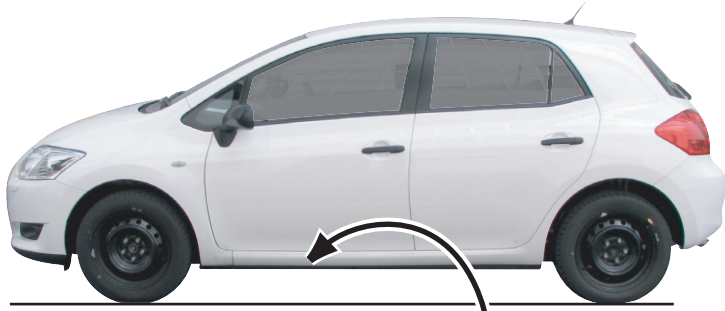

B



4x



CLEANER





+35°C
✓
+15°C



1

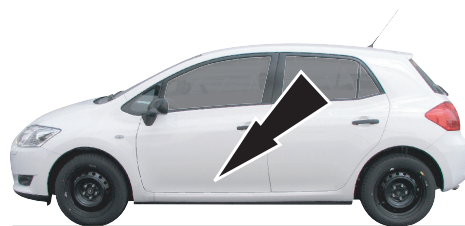

2

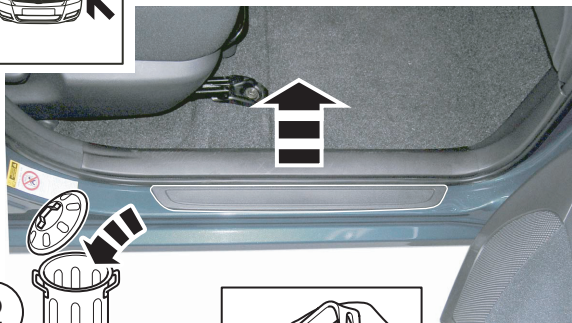
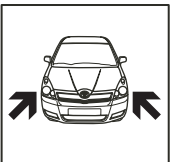

2

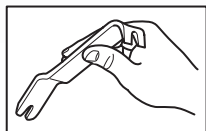

1

3

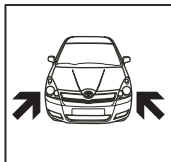

4

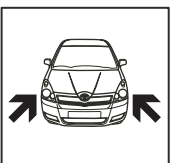

5

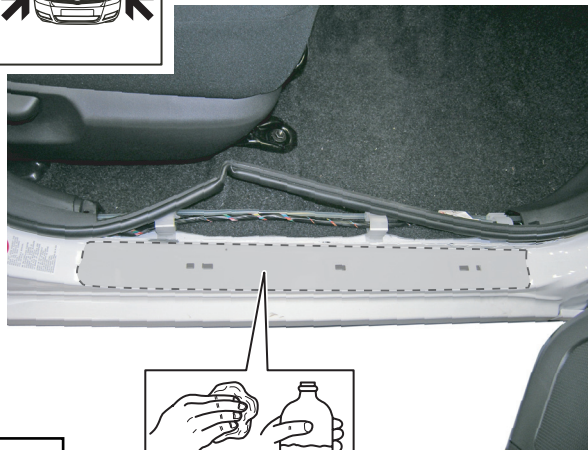
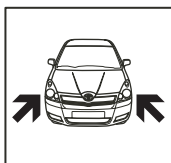

6

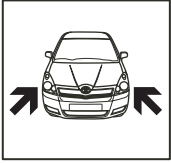

7

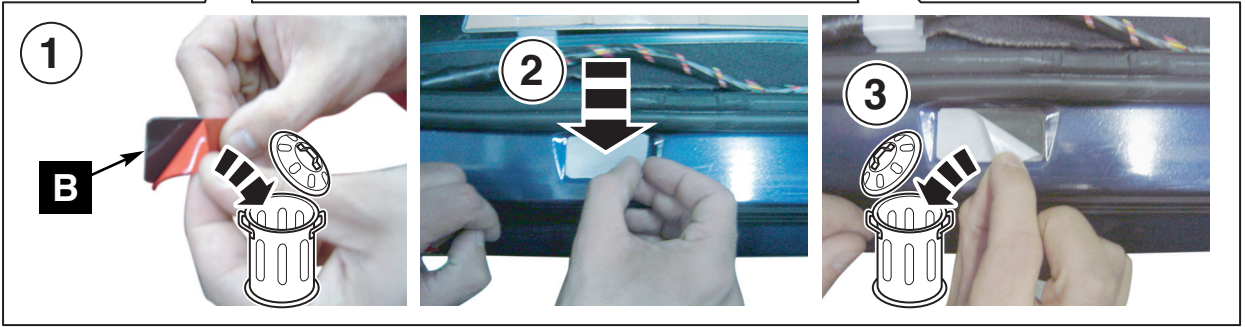

8

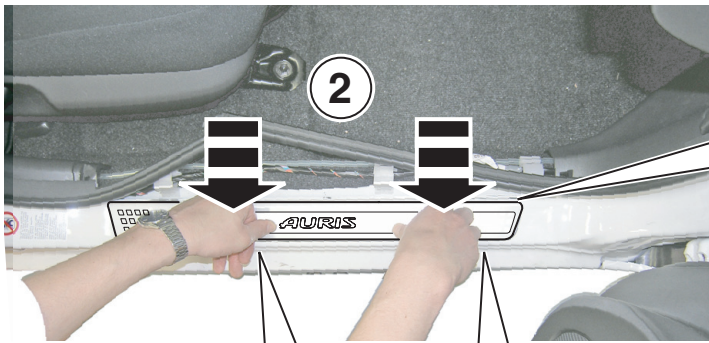
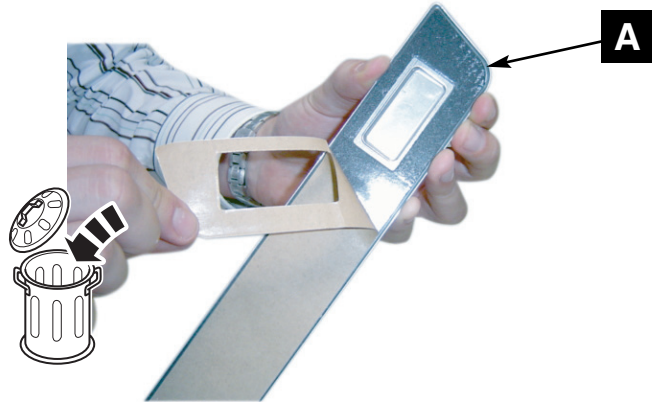

60 sec

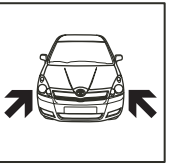

9

